

Safety isolating transformer

Type EP

Single-phase short circuit proof safety isolating transformer designed and tested according to norm EN61558-2-6. Separate insulated windings moulded in self-extinguishing Polyurethane and capsulated in plastic. Insulation class II, double isolated. Short circuit proof and protected against overload. Miniature circuit breaker concerning primary terminals. EP480 and EP960 is thermal protected. Variable secondary output (24-28-30 VAC) by using the 230 or 250 Volt primary terminals. EP models are designed for fixed installation, simple and easy mounting on wall or ceiling.

Applications:

Designed for SELV installation which require safety isolating transformer approved according to the CE directives. Typical installation of heating elements in floors. Also for installation where it is requested to increase the voltage higher than 24V, like floors with hardly any isolation.



Technical specifications

- Input voltage: 187-207-230V
- Frequency: 47-63Hz
- Output voltage: 24-28-30V (reg.)
- According to: EN61558-2-6
- Test/insulating voltage: 4kV AC RMS
- Construction class: II
- Insulation class: B (130°C)
- Ambient temp. (t_a): 40°C
- Degree of protection: IP44, (IP20*)

Wiring diagram

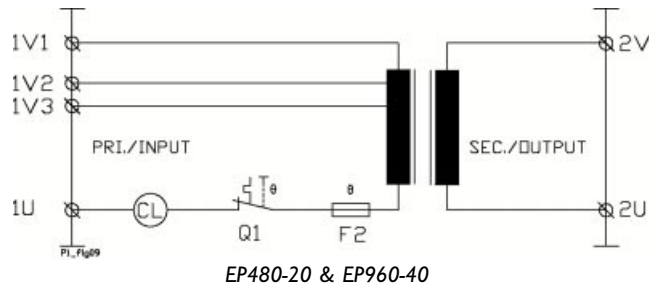
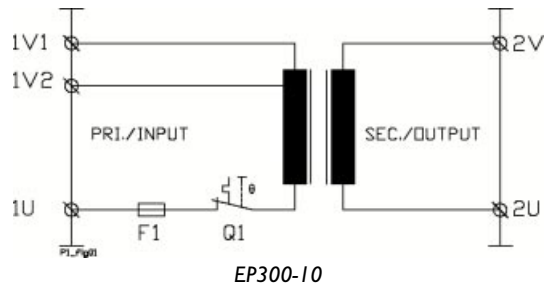

Dimensions

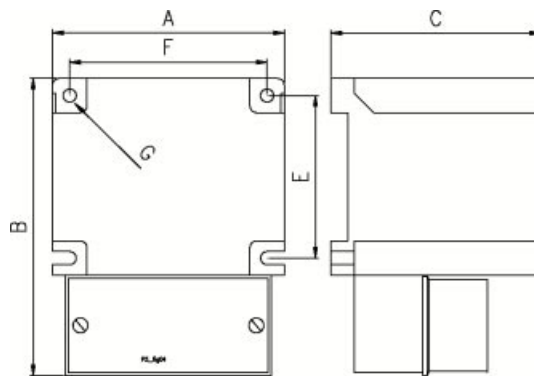

Standard types

Type	Voltage Sec. (V)	Current Sec. (A)	Power (VA)	Fuse (A)	Dimensions AxBxC (mm)	Weight (Kg)	Art. no.
EP300-10 *	24-28	10	300	3,15	106x153x98	4,1	3-050-502300
EP480-20	24-28-30	20	480	Auto	130x202x115	7,9	3-050-502480
EP960-40	24-28-30	40	960	Auto	162x235x140	14,8	3-050-502960