

Stabilised DC power supply

Type LFS

Single-phase electronically stabilised DC power supply. Standard voltages from 12 to 24VDC. Designed and tested according to norm EN60065. Compact design. Separate insulated windings moulded in self-extinguishing polyurethane and capsulated in plastic. Insulation class II. Built-in fuse and electronically protected against short circuit. For fixed installation, simple and easy mounting on wall or ceiling. Output voltage can be fine tuned.

Application:

Designed as power supply to electronic control cards and other electronics requiring stabilised DC voltage. Can under certain circumstances operate combined as power supply and constant voltage battery charger.

Technical specifications

- Input voltage: 230V +/-6%
- Frequency: 47-63Hz
- Output voltage: 12VDC, 14VDC
24VDC
- Max Ripple: 0,5% RMS
- Efficiency: >50%
- Voltage adjustment: <2,5%
- According to: EN60065
- Test/insulating voltage: 4,2kV AC RMS
- Construction class: II
- Insulation class: B (130°C)
- Ambient temp. (t_a): 25°C
- Degree of protection: IP44



Wiring diagram

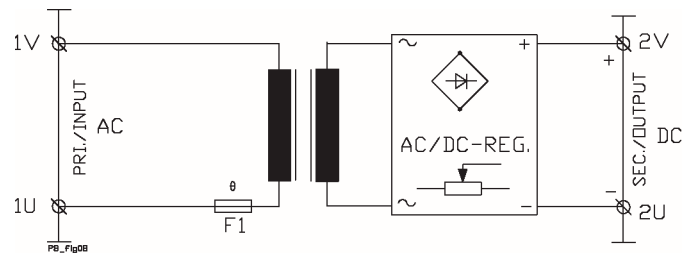

Dimensions

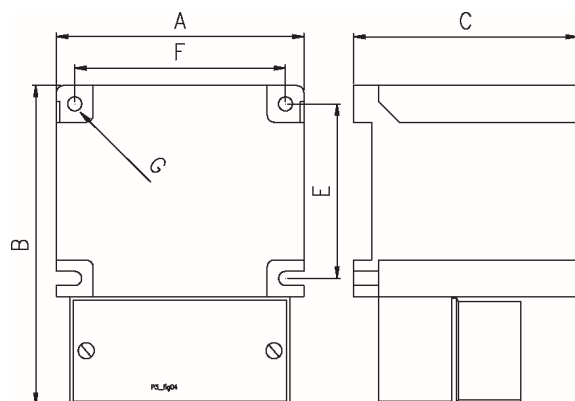

Type	Voltage Sec.DC (V)	Current Sec. (A)	Power (VA)	Losses (W)	Dimensions AxBxC (mm)	Weight (Kg)	Art. no.
LFS 26-12	12	2,2	26	26	92x130x87	1,7	3-190-500402
LFS 30-14	14	2,2	30	21,5	92x130x87	1,7	3-190-500400
LFS 24-24B	24	1,0	24	12	83x111x78	1,2	3-190-500391
LFS 38-24	24	1,6	38	23,5	92x130x87	1,7	3-190-500401