

Stabilised DC power supply

Type HAS

Single-phase electronically stabilised DC power supply. Standard voltages from 5 to 28 VDC. Designed and tested according to norm EN60065 and approved by NEMKO, SEMKO, FIMKO and DEMKO. Compact design. Separate insulated windings moulded in self-extinguishing polyurethane and capsulated in plastic. Insulation class II. Built-in fuse and electronically protected against short circuit. Output voltage can be adjusted 10% using a built-in potentiometer. Portable design with mounted mains voltage cable (2m) and EUR-plug, secondary cable 1m.

Application:

Designed as power supply to electronic control cards and other electronics requiring stabilised DC voltage. Can under certain circumstances operate combined as power supply and constant voltage battery charger.

Technical specifications

- Input voltage: 230V +/-6%
- Frequency: 47-63Hz
- Output voltage: 5VDC - 28VDC
- Max Ripple: 0,2% RMS
- Efficiency: >44%
- Voltage adjustment: ±10%
- According to: EN60065
- Test/insulating voltage: 4kV AC RMS
- Construction class: II
- Insulation class: B (130°C)
- Ambient temp. (t_a): 40°C
- Degree of protection: IP44

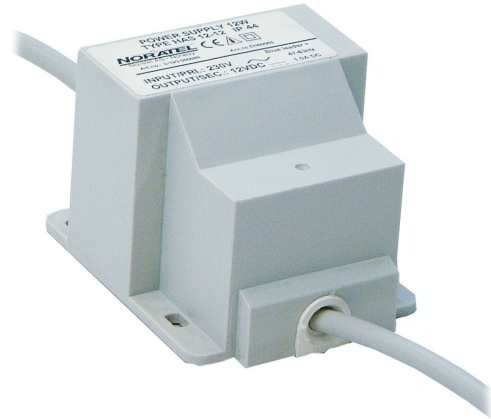

Wiring diagram

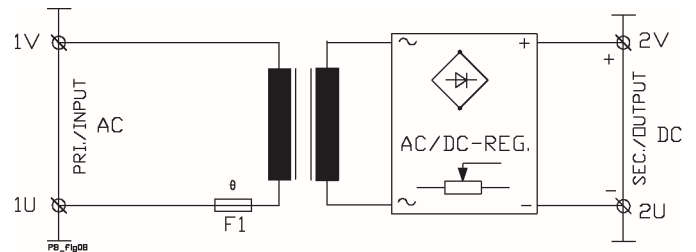

Dimensions

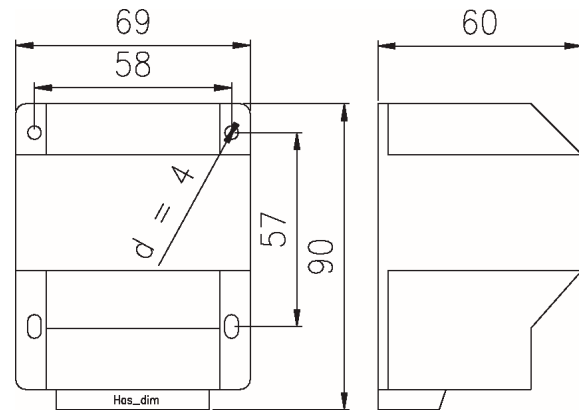

Type	Voltage Sec.DC (V)	Current Sec. (A)	Power (VA)	Losses (W)	Dimensions AxBxC (mm)	Weight (Kg)	Art. no.
HAS 8-5	5	1,5*	8	13	69x90x60	1,0	3-190 500060
HAS 9-6	6	1,5*	9	14	69x90x60	1,0	3-190 500070
HAS 14-9	9	1,5*	14	17	69x90x60	1,0	3-190 500100
HAS 12-12	12	1,0	12	13	69x90x60	1,0	3-190 500080
HAS 14-14	13,8	1,0	14	14	69x90x60	1,0	3-190 500110
HAS 14-15	14,4	1,0	14	13	69x90x60	1,0	3-190 500120
HAS 12-24	24	0,5	12	10	69x90x60	1,0	3-190 500090
HAS 17-24	24	0,7	17	12	69x90x60	1,0	3-190-500260
HAS 14-28	27,6	0,5	14	9	69x90x60	1,0	3-190 500130